

Graham Optical Systems announces our Newest product – the **VersaStage™** – an invertible Tip/Tilt/Rotate Stage that offers a versatility not commonly found in other stages.

Used as shown in the drawing at the left, the **VersaStage** permits the operator to adjust the rotation angle of the stage

with respect to the bench top and then, independently adjust the Tip/Tilt angles with respect to the bench top.

At the right is a drawing of the **VersaStage** when used in the inverted position. This permits the operator to adjust the Tip/Tilt angles with respect to the bench top and then adjust the rotation angle in the plane of the Tilt Plate.

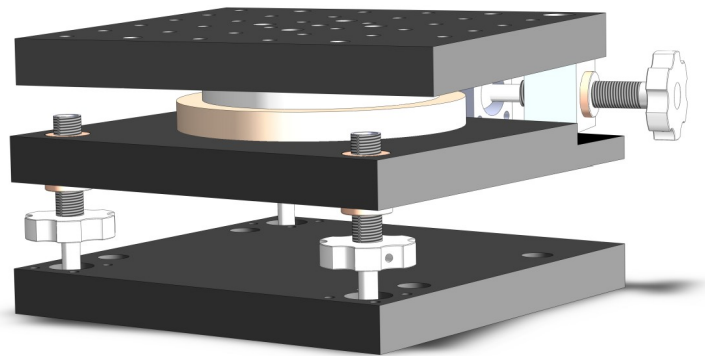

This versatility is accomplished by providing two sets of holes in both the upper and lower plate: ¼-20 tapped holes on 1-inch centers and several counterbored through-holes to attach the stage to the work bench. This series of stages will be offered in several sizes: 6" x 6", 8" x 8", 10" x 10", 12" x 12" and 18" x 18".

As an introduction to this product line, for a limited time, we are offering the 6" x 6" Model 6X6TTR **VersaStage** at the greatly reduced price of \$995.00

In the coming weeks, we will also be offering a **VersaStage** in a Tilt/Rotate format.

Please call Gordon Graham at (818) 700-1263 for further information.

Major Credit Cards accepted.

Thank you for your attention.